

4

## Framework & Capital Plans Alignment



# Boswell & Jones Phasing

## Phase 1 Ewell & McGlothlin-Street

- Boswell and Jones halls are in poor condition and should be replaced to facilitate the redesign of New Campus's southwest corner.
- With the completion of the Music Arts Center and soon the ISC IV, departments in Ewell and McGlothlin-Street have moved or will move to these new buildings.
- Ewell and McGlothlin-Street can then be renovated first to create new swing space for Boswell and Jones.

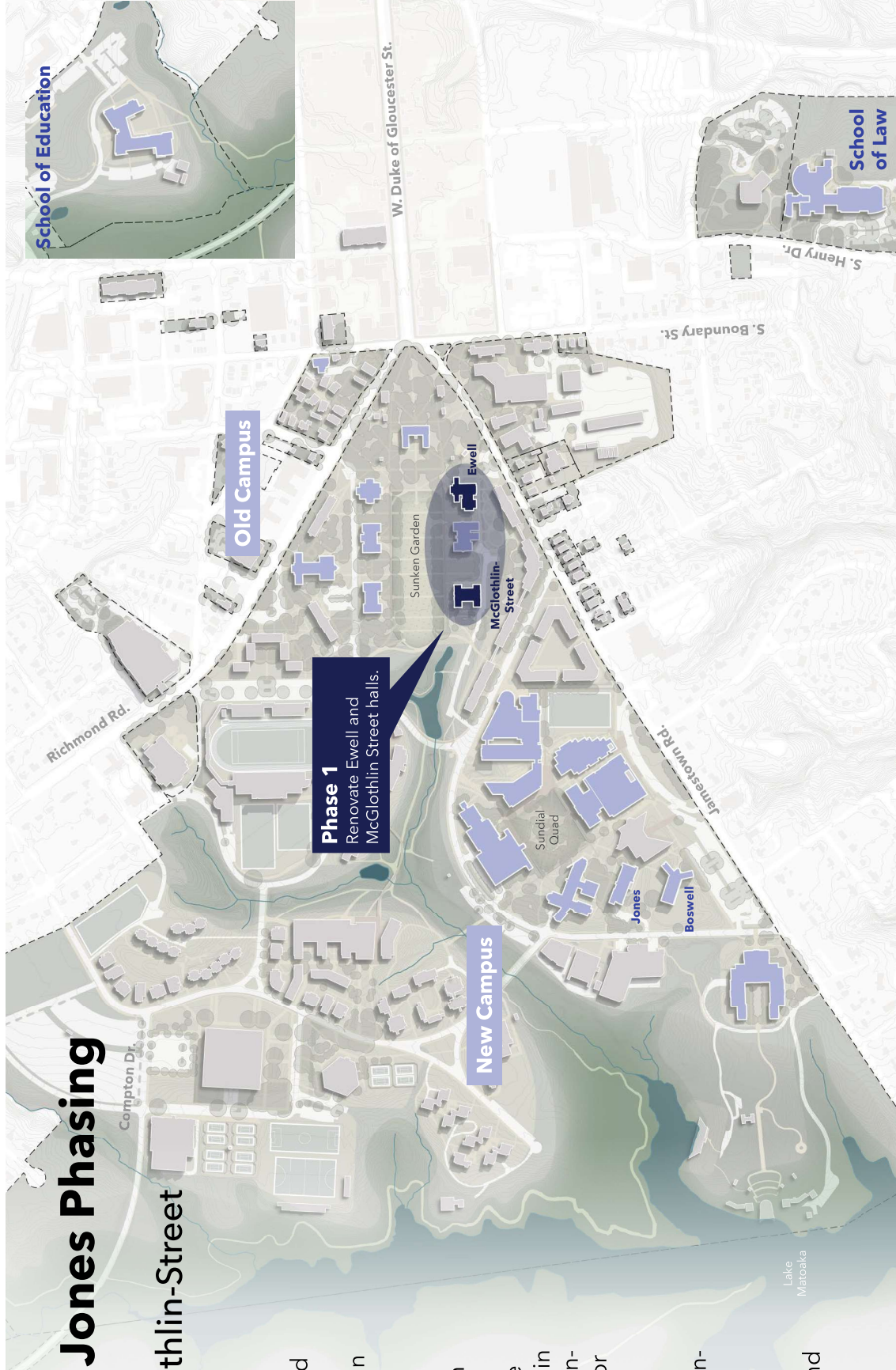

# Ewell Hall

## Renovation Concept | Floor 1

- Renovation category D: **major/gut renovation** integrated with building-wide program, infrastructure, and accessibility goals.
- Reconfigure and combine classrooms to create **right-sized active learning spaces** that can serve many disciplines.
- Improve overall interior and exterior **accessibility and flow**, including reconnecting the two parts of the building.
- Imagine new Commons with study and informal learning spaces.



# Ewell Hall

## Renovation Concept | Floor 1

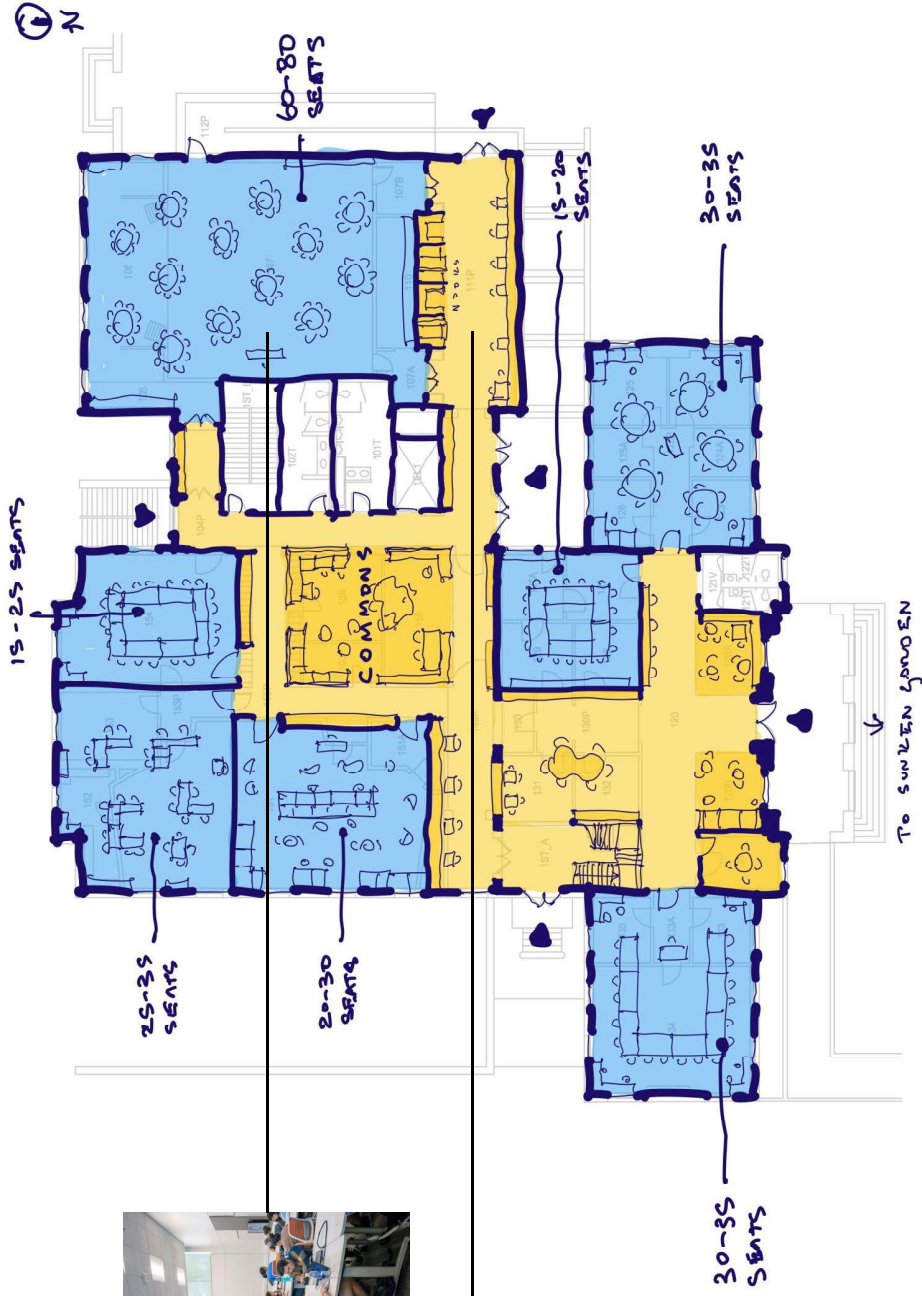
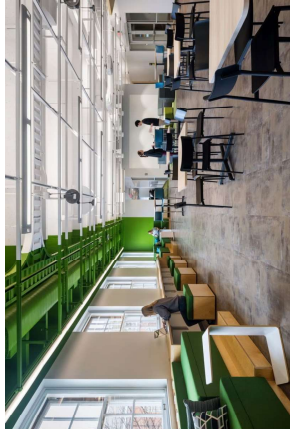

# McGlothlin-Street Hall

## Renovation Concept | Floor 1

- Renovation category D: **major/gut renovation** integrated with building-wide program, infrastructure, and accessibility goals.
- Reconfigure vacated offices and out-of-date classrooms to create **right-sized active learning spaces** that can serve many disciplines.
- Improve overall interior and exterior **accessibility and flow**.
- Reimagine circulation areas with comfortable, flexible **informal learning and social spaces**.
- Create new **Humanities Innovation Center** on the basement level.

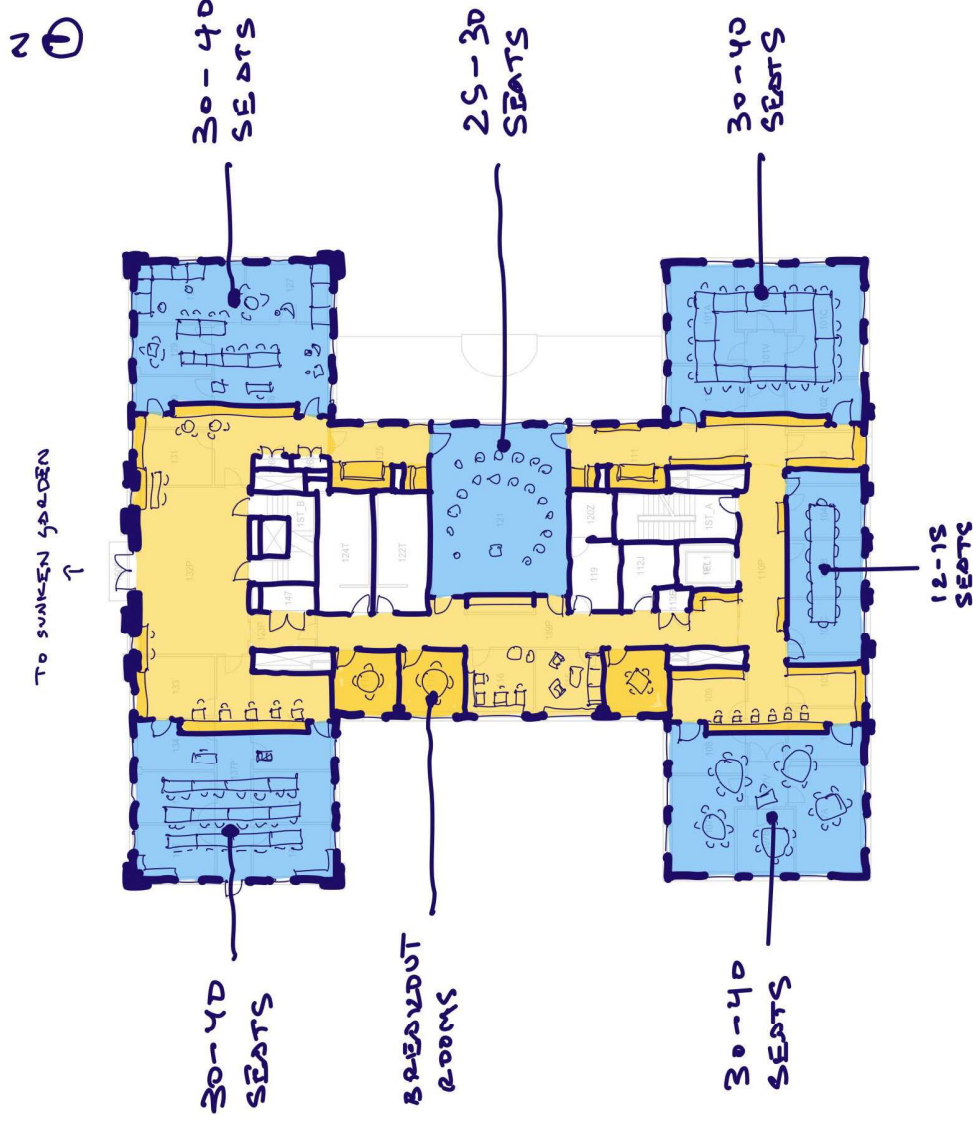

# McGlothlin-Street Hall

## Renovation Concept | Floor 1

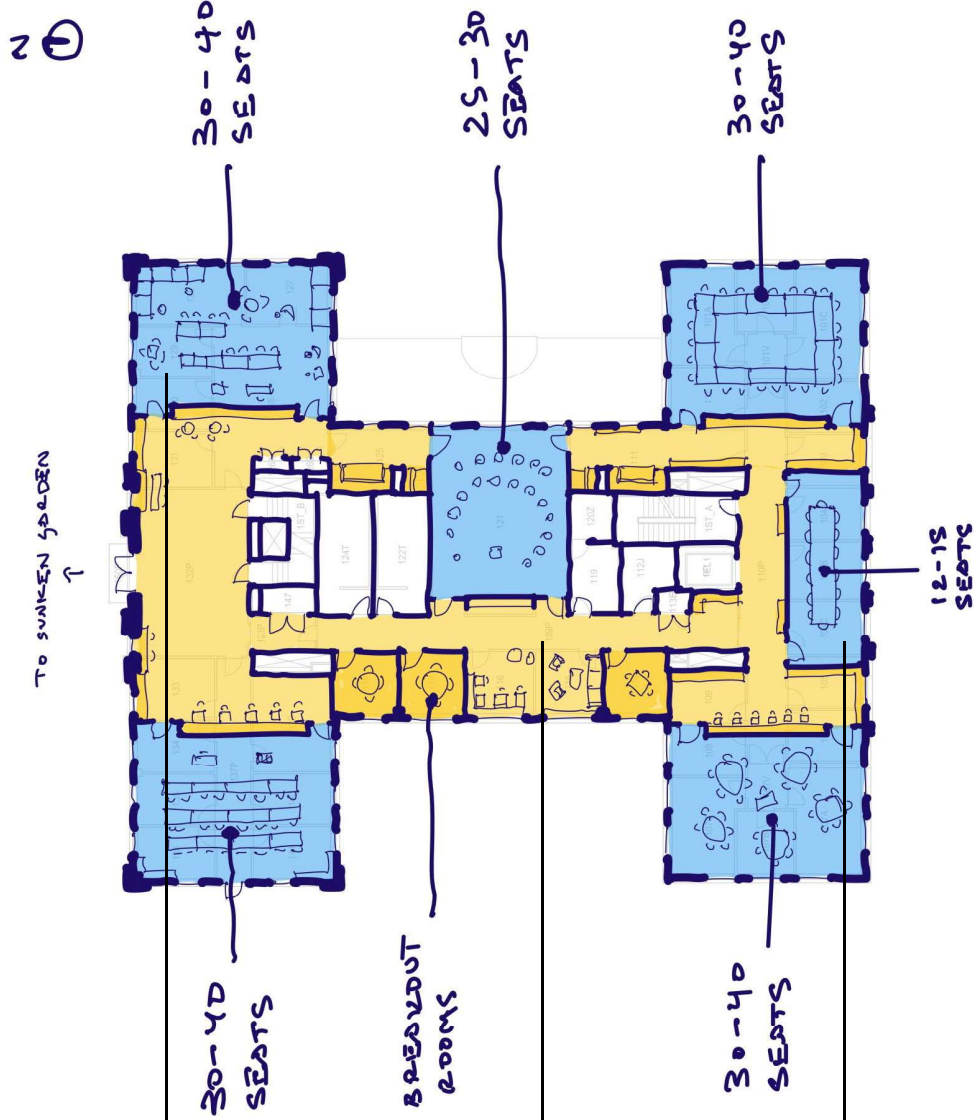
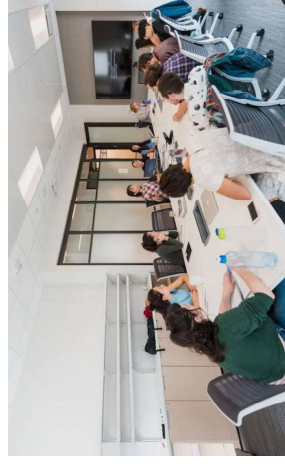
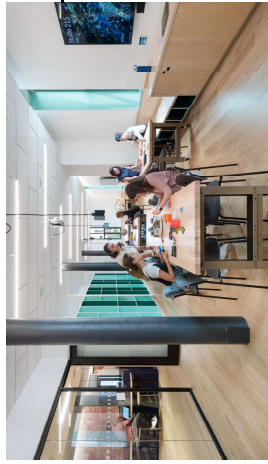

# Boswell & Jones Phasing

## Phase 1 Ewell & McGlothlin-Street

- With the completion of the Music Arts Center and ISC IV, departments in Ewell and McGlothlin-Street have moved or will move buildings.
- These halls can be renovated first to open up new swing space for Boswell and Jones halls.

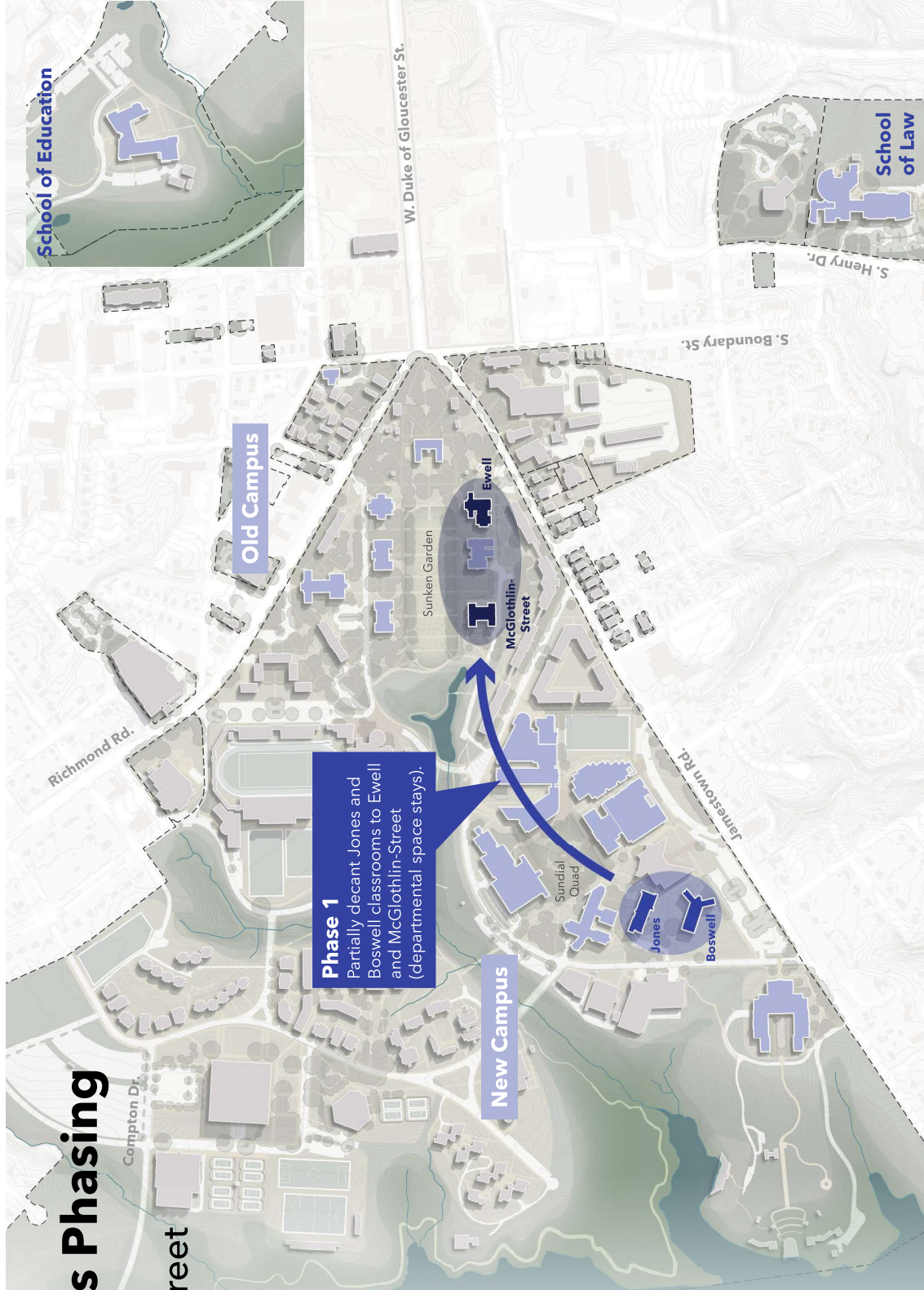

# Boswell & Jones Phasing

## Phase 2

### Jamestown Road

- After or while renovating Ewell and McGlothlin Street, a new academic building can be constructed along Jamestown Road as the first phase of the Boswell-Jones site work while maintaining Boswell and Jones.

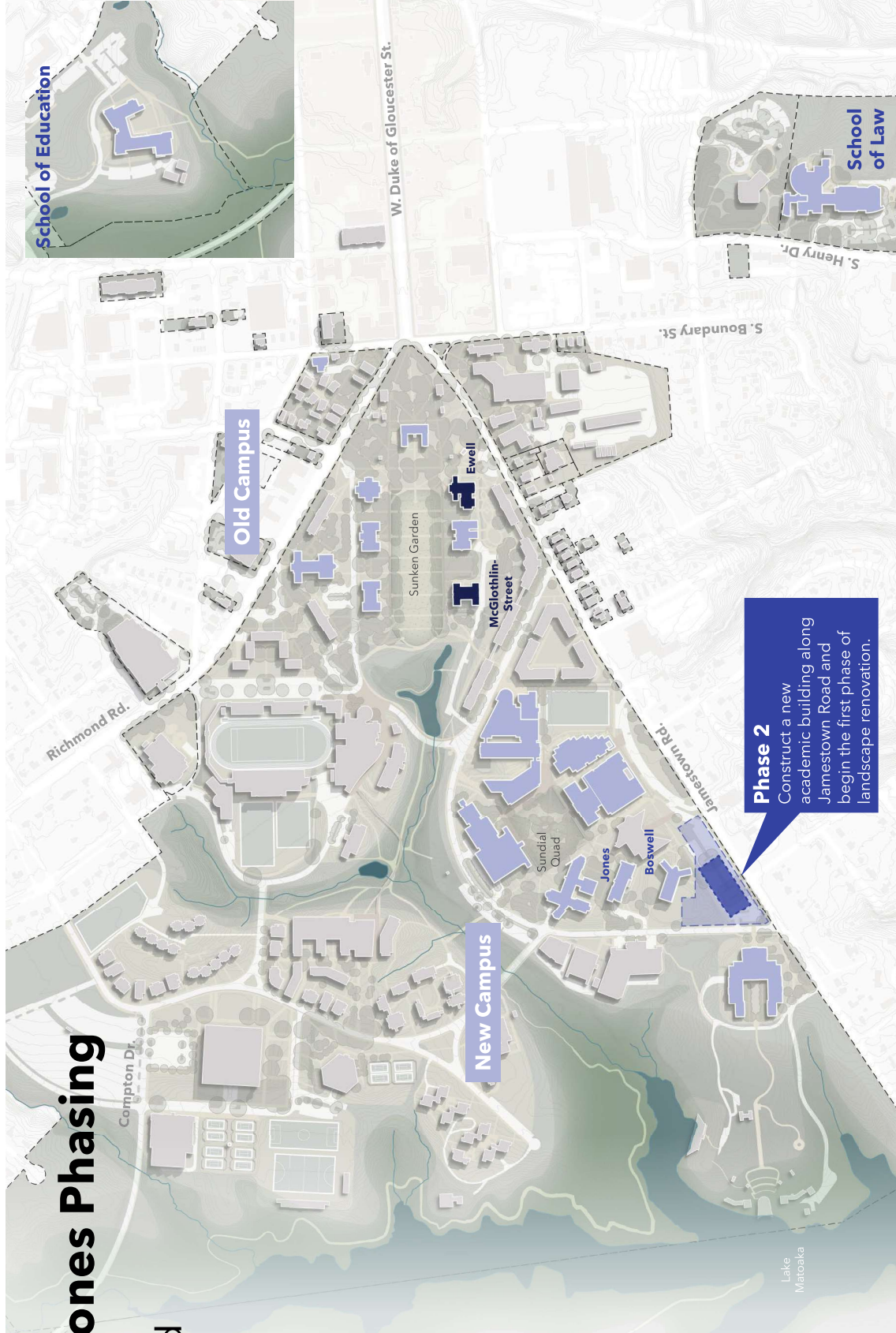



# Boswell & Jones Phasing

## Phase 2 Jamestown Road

- Once construction is complete, the remainder of Boswell and Jones can be decanted into the new building.

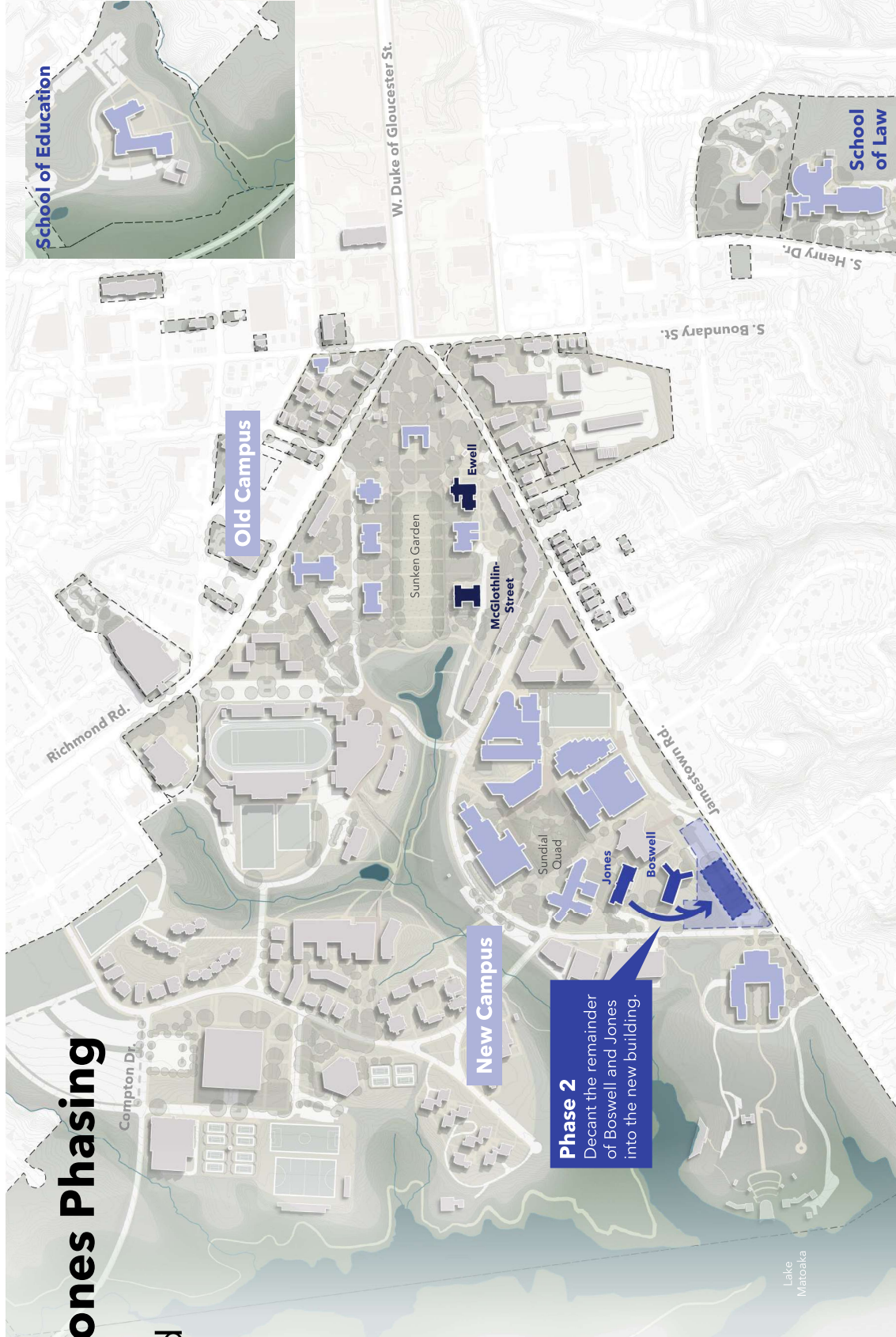

# Boswell & Jones Phasing

## Phase 3 Demolish & Rebuild

- Once Boswell & Jones have been emptied, they can be demolished and the site prepared for new construction.

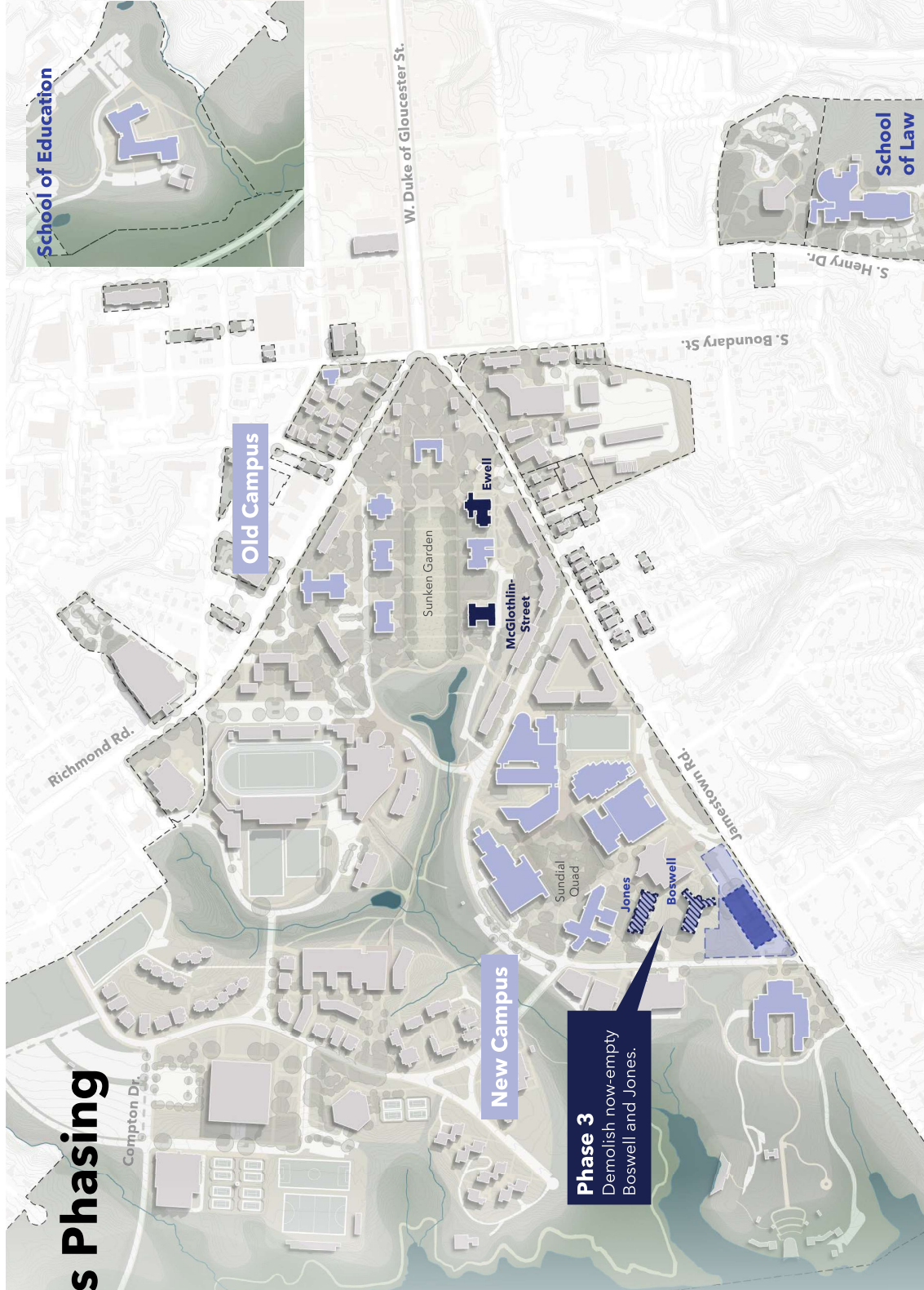

# Boswell & Jones Phasing

## Phase 3 Demolish & Rebuild

- With Boswell and Jones demolished, a second new academic building can be constructed, and the comprehensive landscape renovation can be completed.

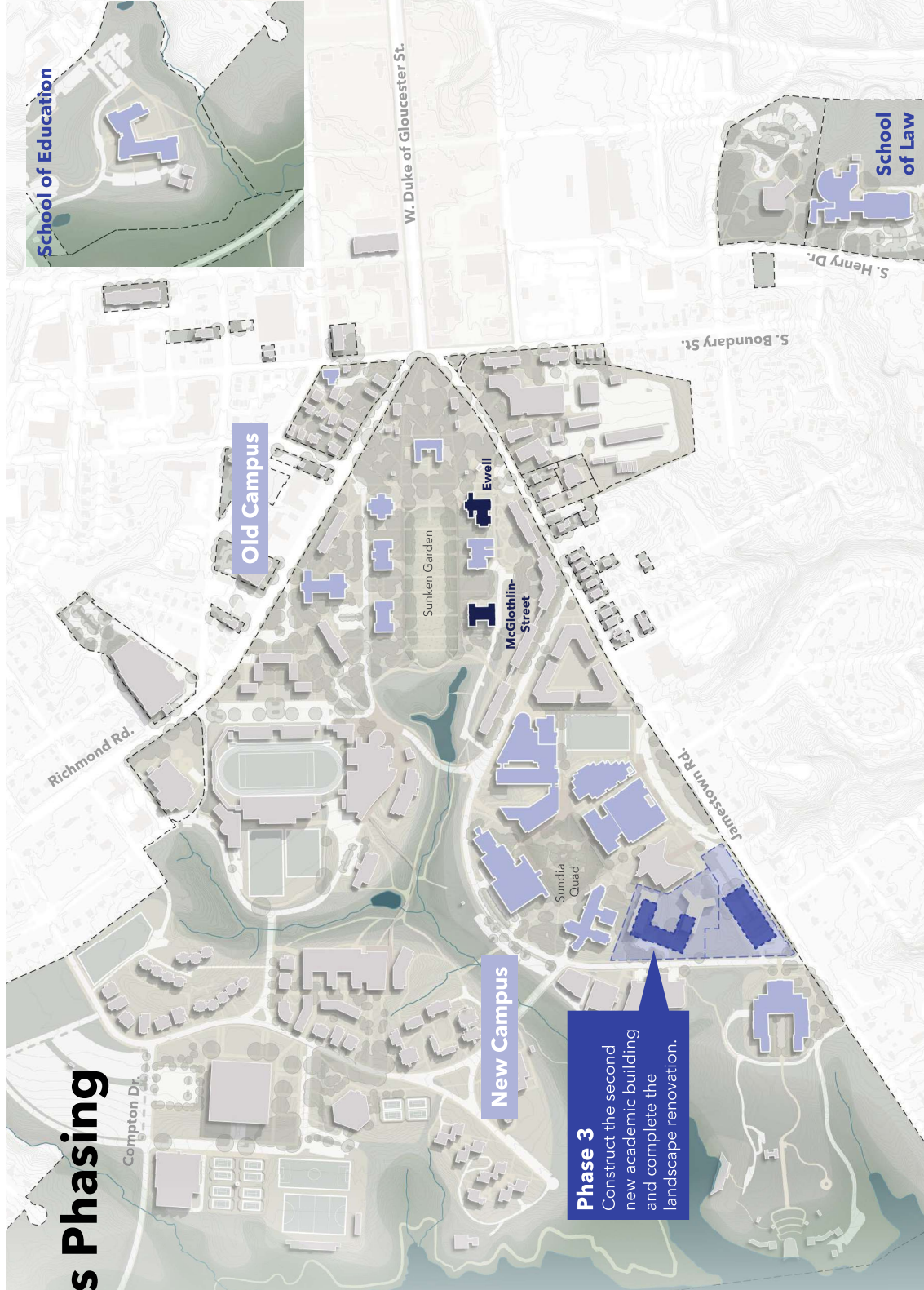

## Additional Considerations



# Classroom Optimization | Proposed Room Modifications

- A second stage of more extensive renovations entails strategic **combination or division of classrooms** to further optimize the classroom size ranges.

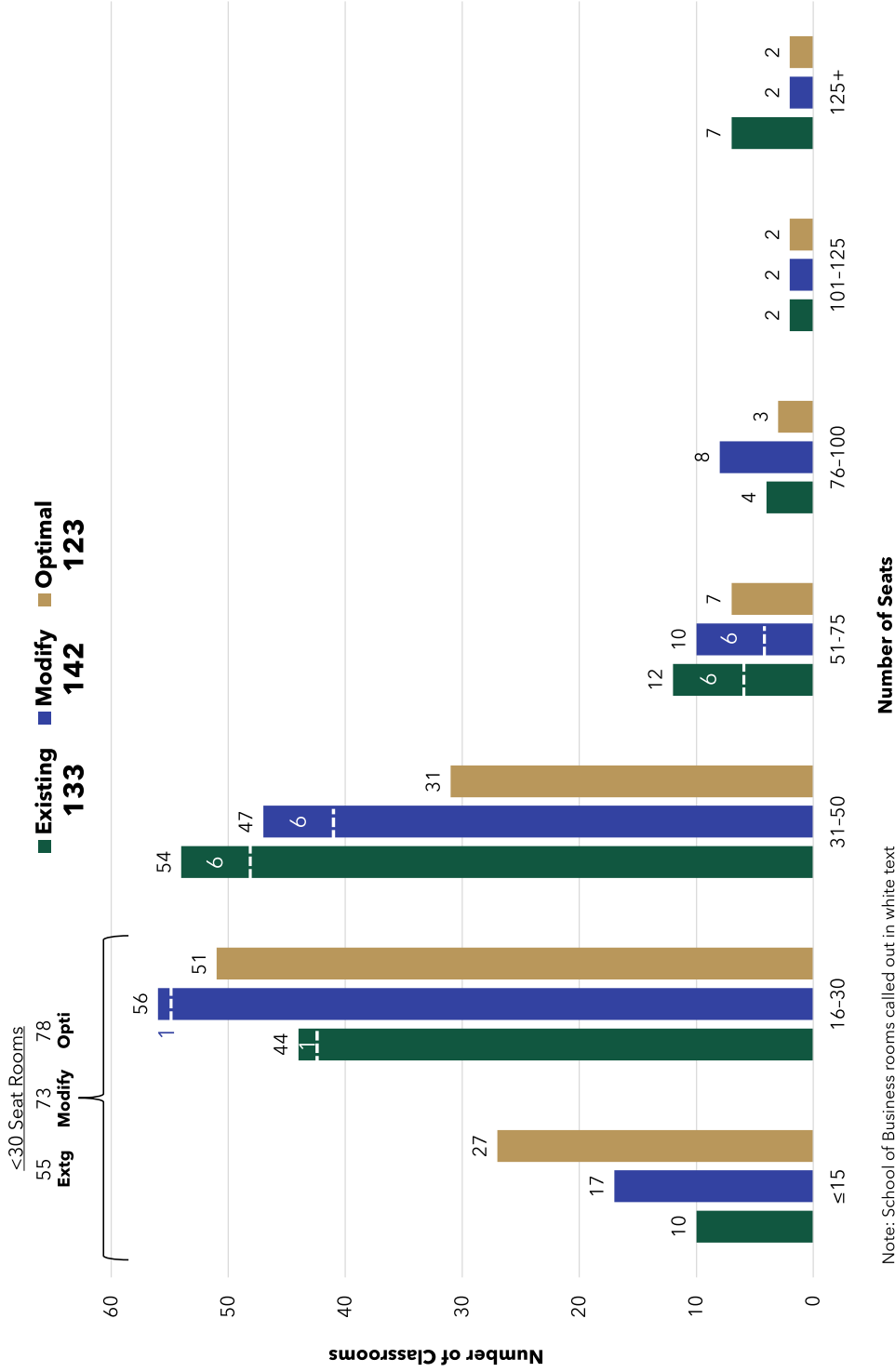

Note: School of Business rooms called out in white text

# James Blair Hall



Level 2



229 (50 seats)

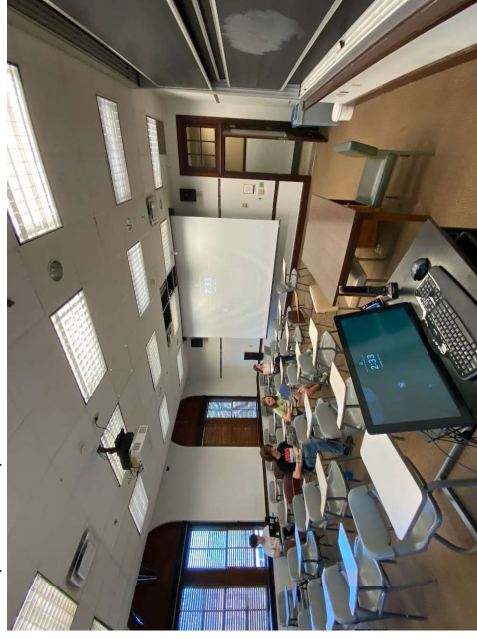

201 (42 seats)

# Washington Hall

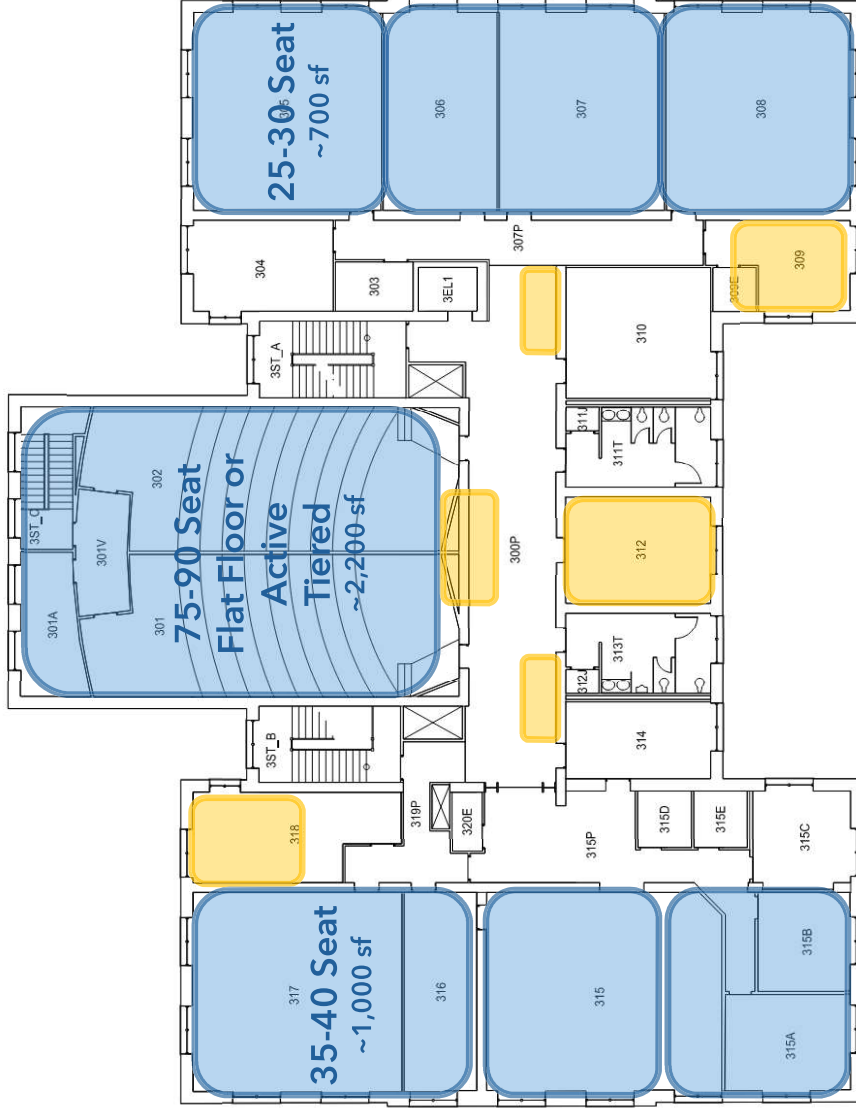

Level 3



302



307

# Small Hall

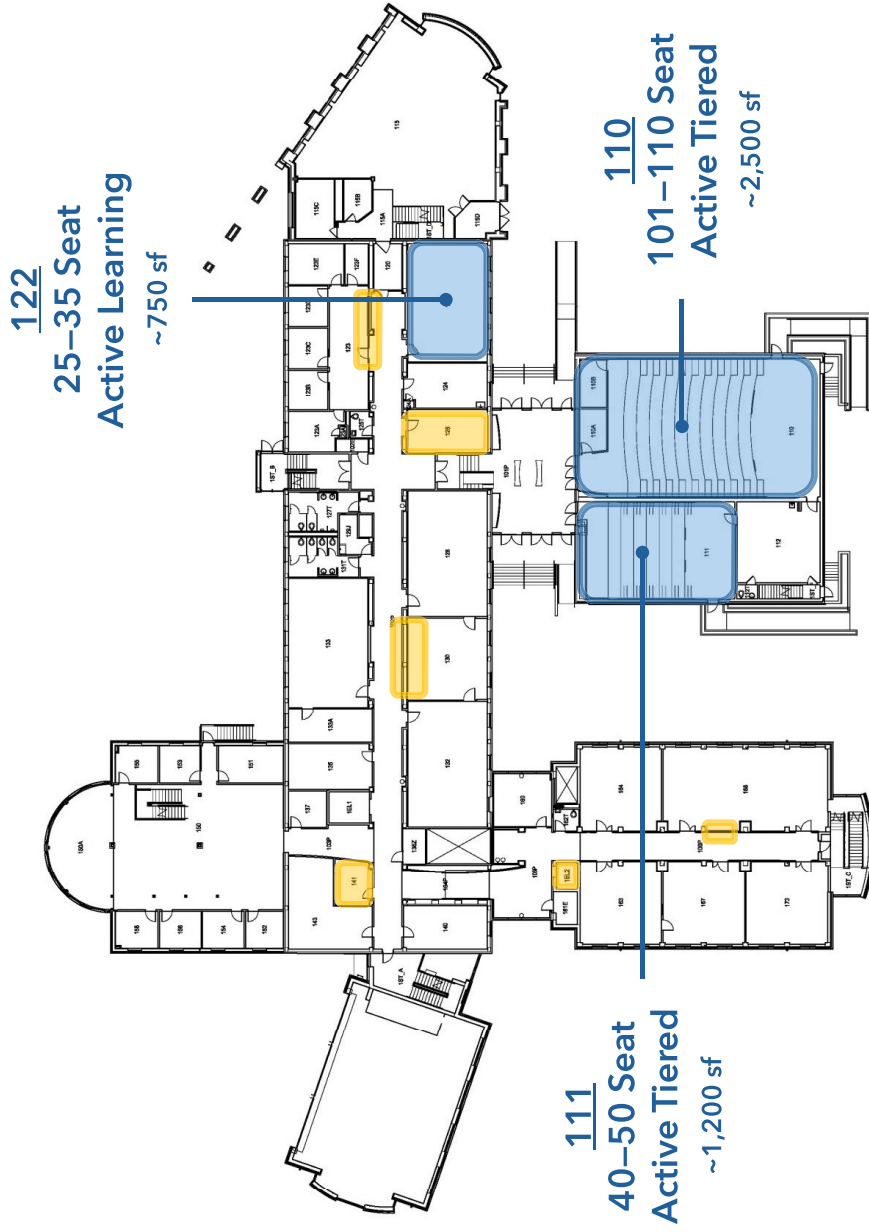

Level 1





# Small Hall

253 & 255  
2x 15-25 Seat  
Seminar/Active  
~550 sf

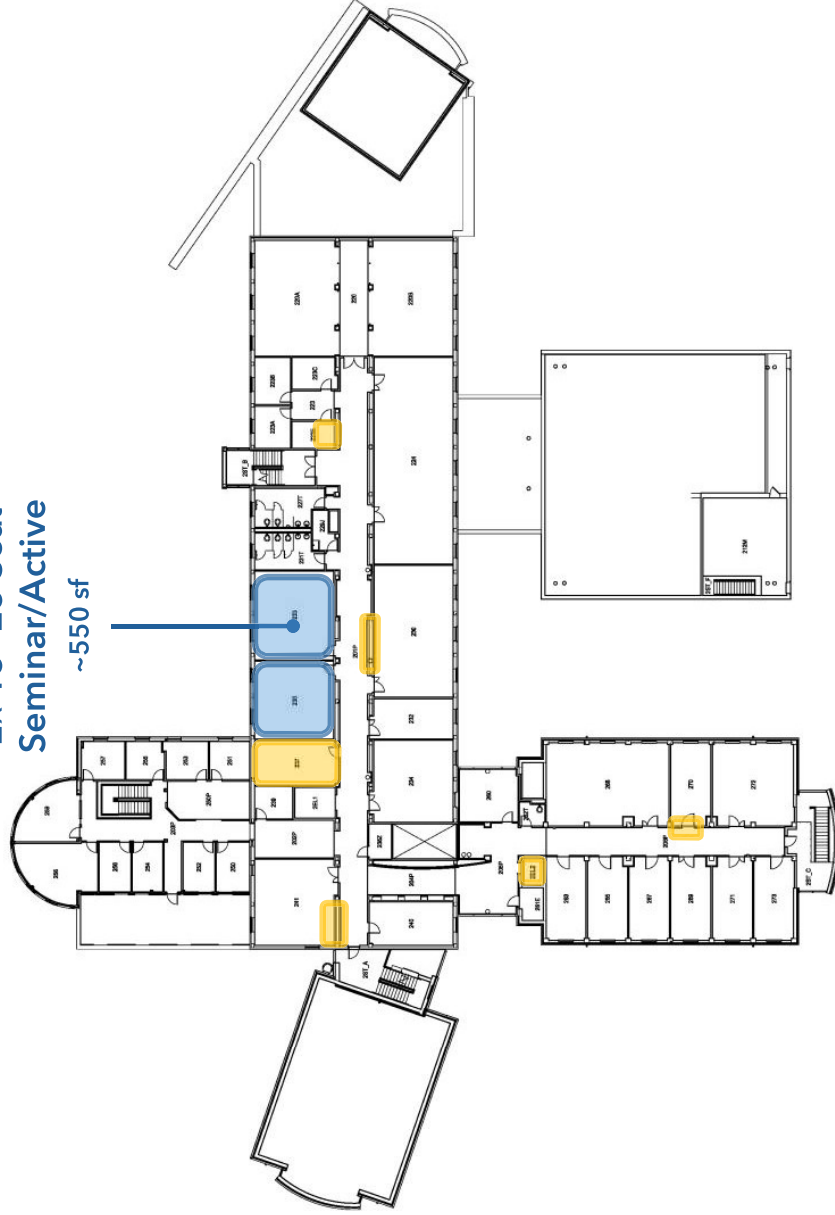

Level 2

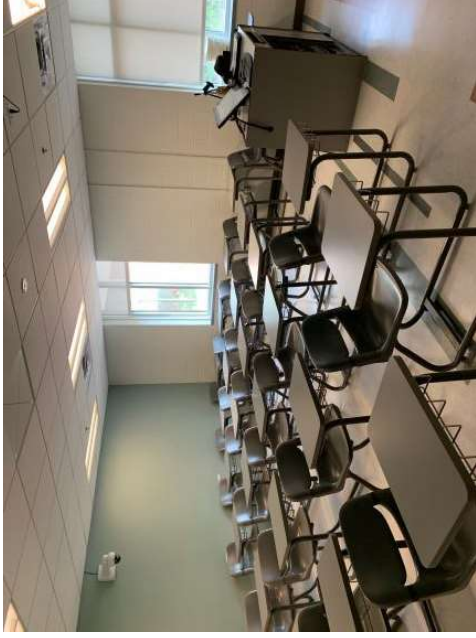

235

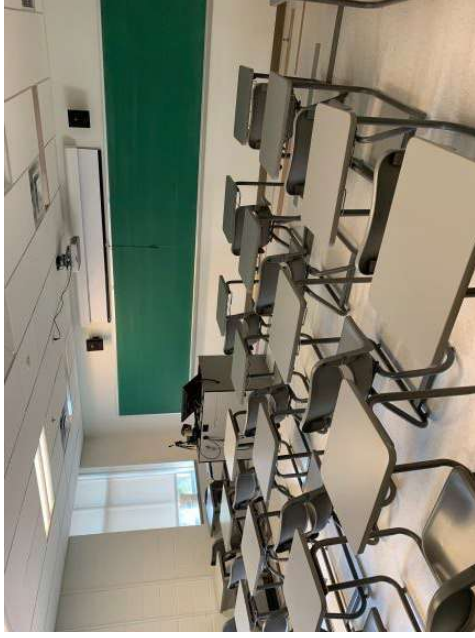

235

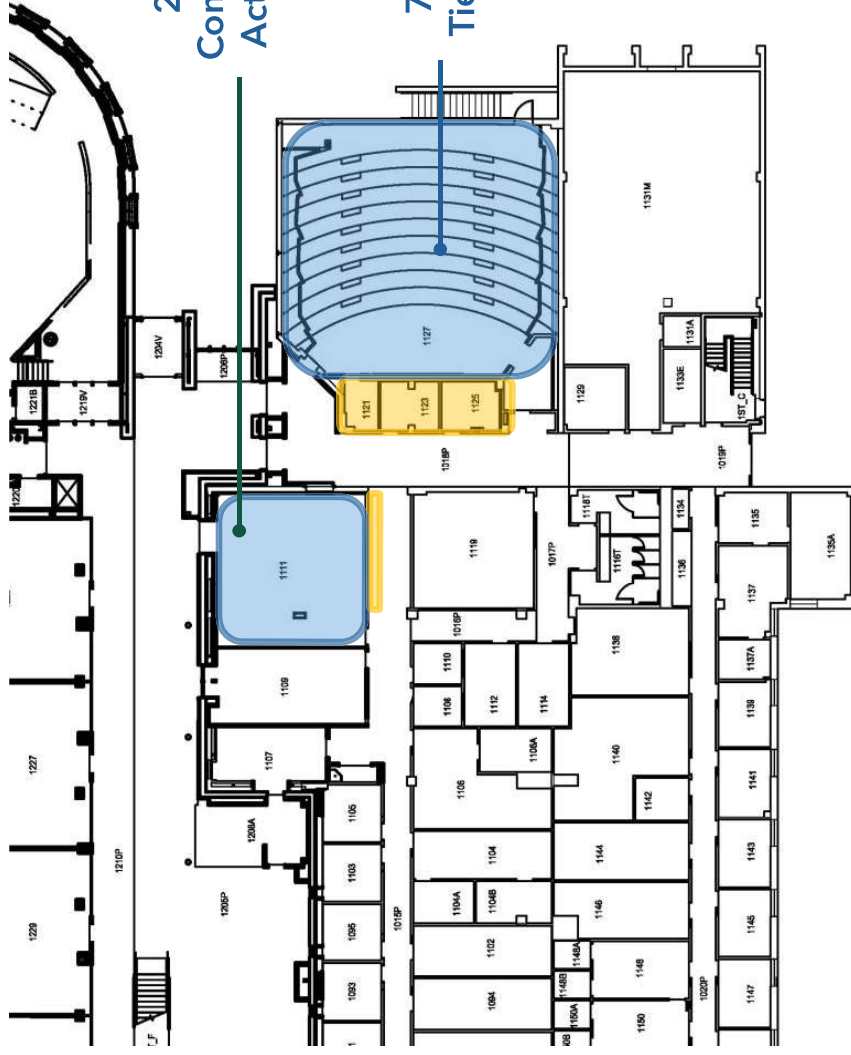

**1111**  
**20-30 Seat**  
**Computer Lab or**  
**Active Learning**  
 ~800 sf

**1127**  
**70-90 Seat**  
**Tiered Lecture**  
 ~2,000 sf

**Level 1**

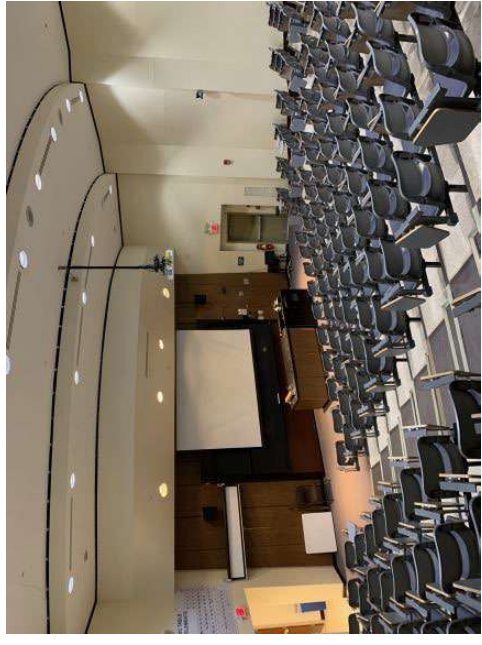

1127



1111

# 6 Questions & Discussion

